

TRIKKE™ T8 CONVERTIBLE

Wheel replacement (conversion)

TOOLS

Allen wrench 5 mm (2x), 4 mm and 2 mm
Pair of pliers
Flat screwdriver



Place the trikke upside down on a bench.



Remove the wheel

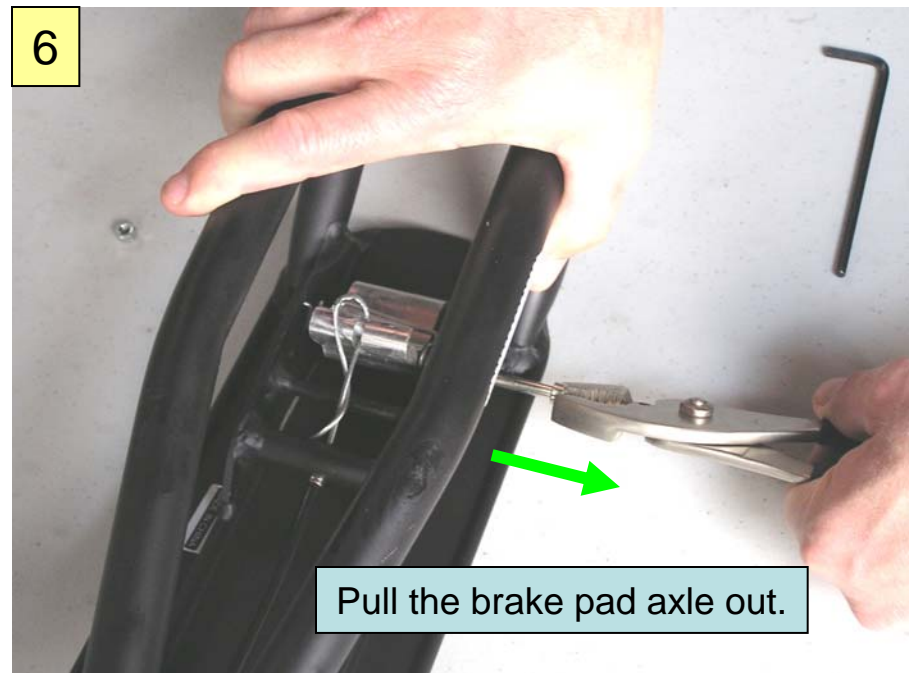
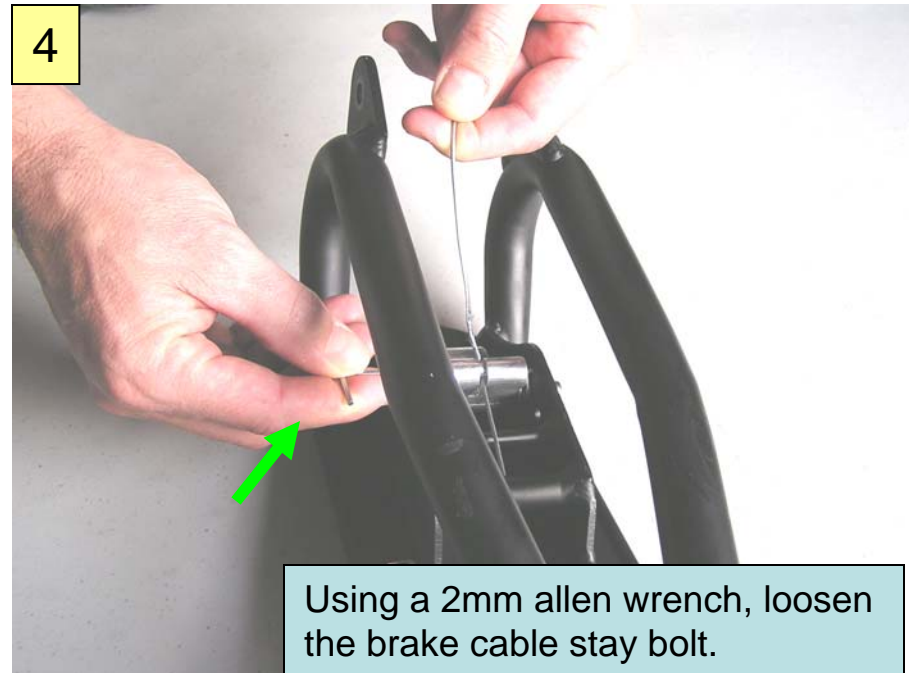

7

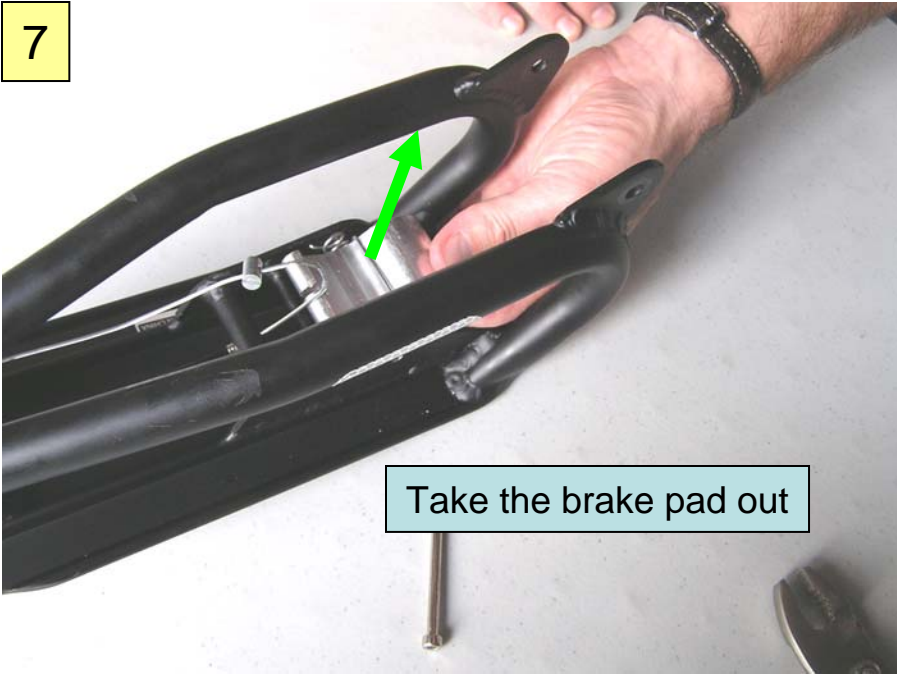

Take the brake pad out

8

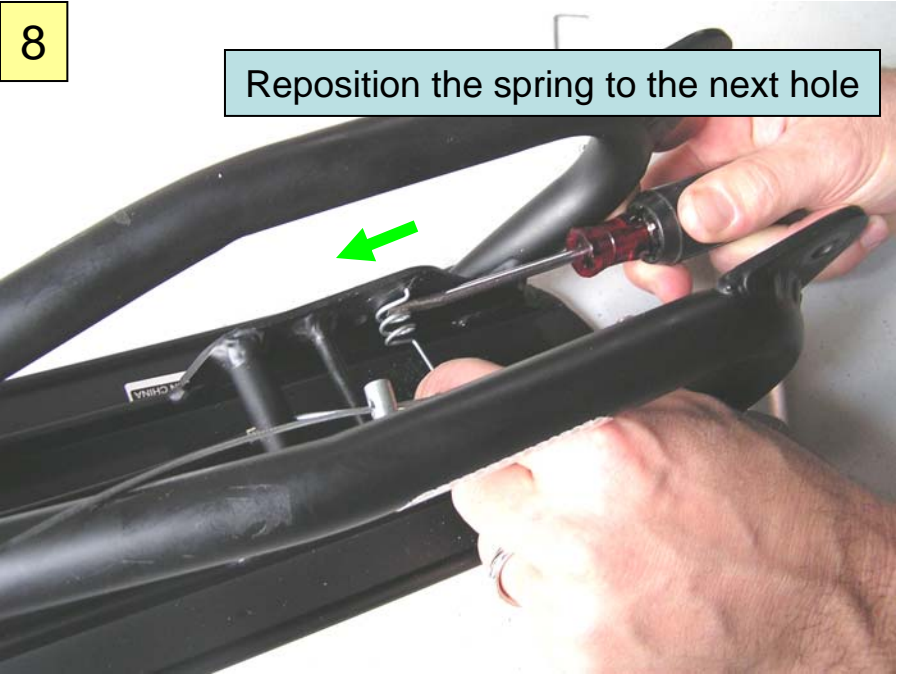

Reposition the spring to the next hole

9

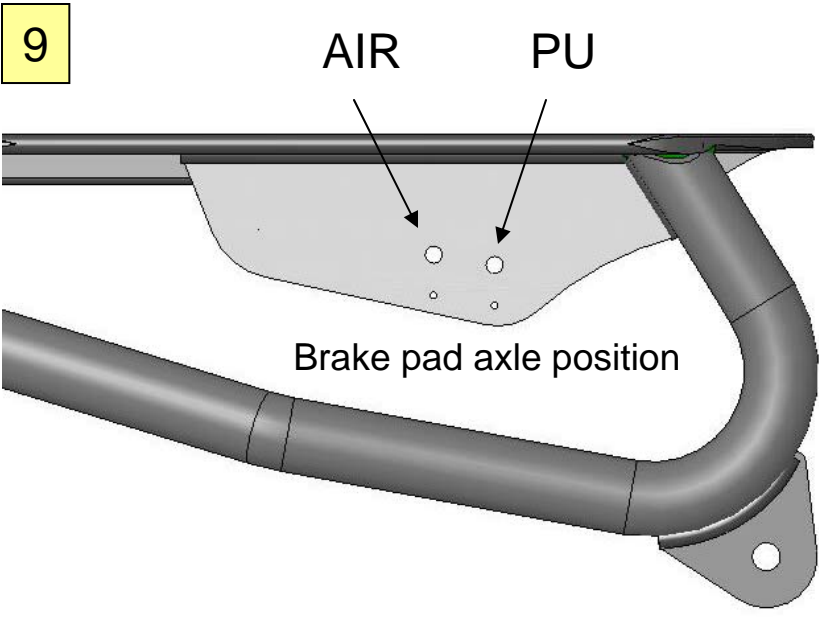

Brake pad axle position

10



Reinstall the brake pad on the new position

PS – if you have received a pair of pads with the wheels, install the new pads.

11



Engage the brake cable stay in the pad's slot.

12



Assemble the new wheel to the trikke. Make sure washer and spacer are properly placed

13



Tighten the wheel axle

14

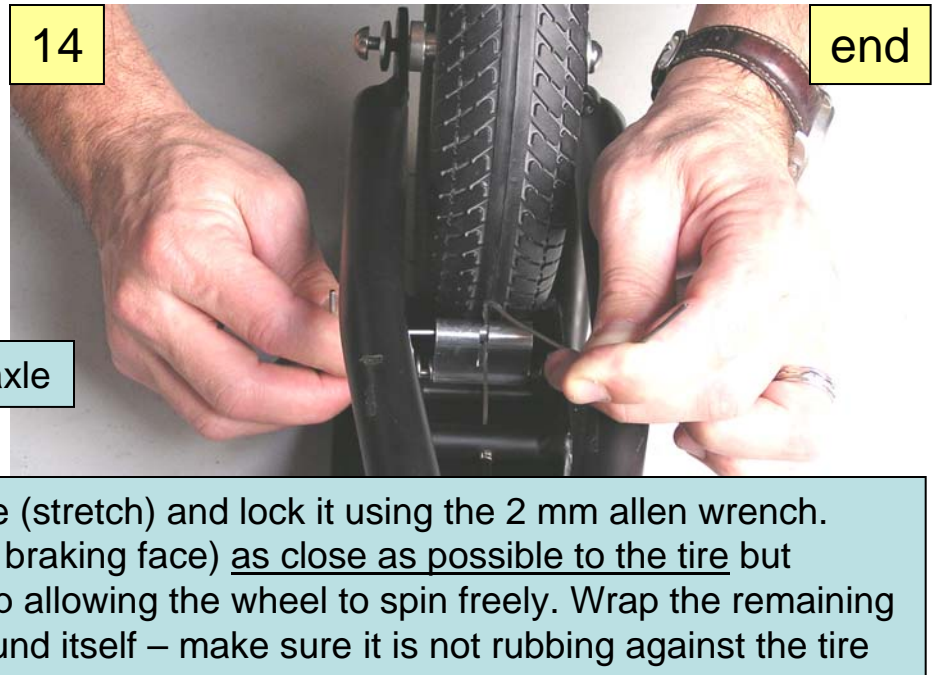

end

Pull the brake cable (stretch) and lock it using the 2 mm allen wrench. Adjust the pad (the braking face) as close as possible to the tire but keeping a small gap allowing the wheel to spin freely. Wrap the remaining length of cable around itself – make sure it is not rubbing against the tire